

MAX 26 T2 0,37kW

Series general data MAX



MANUFACTURING FEATURES

- Rolling steel sheet housing.
- Cast aluminium impeller.
- Epoxy powder finishing coat.
- Standard asynchronous squirrel-cage motor with IP-55 protection and Class F insulation and ATEX certified EEx-d. Manufactured with standard voltages: 230/400V 50Hz in three phase motors.

APPLICATIONS

- Designed for inline installation, they are suitable for:
- General ventilation in closed environments classified as ATEX zone 2.
 - Maximum working temperature: carried air -20°C; environment: 80°C.

UNDER REQUEST

- 60Hz fans and special voltages.
- ATEX for different categories.

In compliance with the 94/9/CE Directive. ATEX II2G built. Certified II3G with certified ATEX EEx-d II2G motor for areas 2 (gas) or 22 (dust).

Series accessories MAX



Characteristic curve

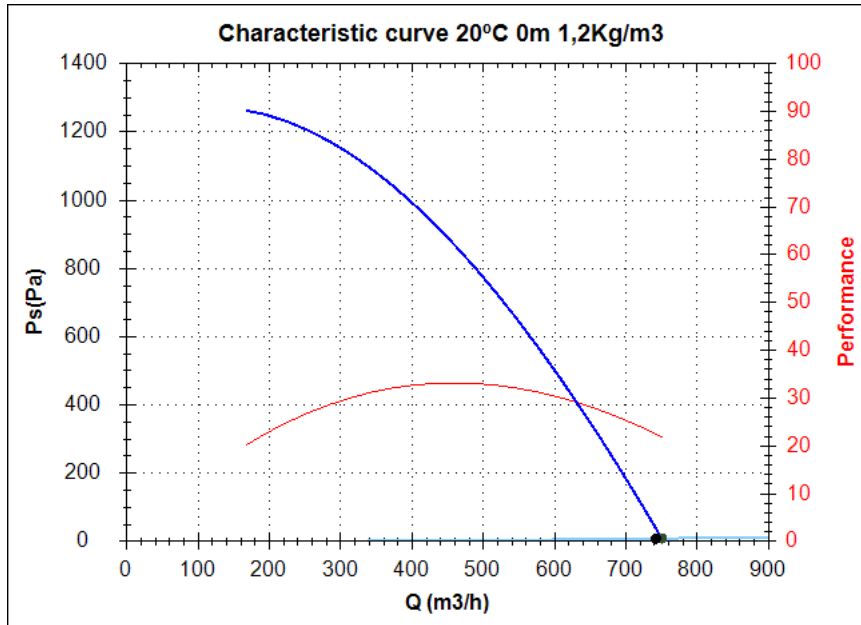

Design point

Q (m3/h)	741,87
Ps(Pa)	8,85

Service point

Impeller rpm	2800
Max. temp.(°C)	130
Q (m3/h)	750,35
Ps(Pa)	9,06
Pd(Pa)	288,53
Pt(Pa)	297,59
Air speed(m/s)	21,93
Perf.(%)	21,87
SWL dB(A)	90 (INLET)
SPL dB(A)	75 (INLET)
Distance(m)	1,5

Technical data

Impeller rpm	2800
Motor rpm	1
Approx. weight(kg)	13
Maximum flow rate(m3/h)	750

Power(kW)	0,37
Imax 230V(A)	1,65
Imax 400V(A)	0,95
Imax 690V(A)	-

MAX 26 T2 0,37kW

Acoustics to the service point (INLET)

Power dB(A)

63 Hz	39
125 Hz	61
250 Hz	77
500 Hz	82
1000 Hz	86
2000 Hz	83
4000 Hz	78
8000 Hz	69
Total dB(A)	90

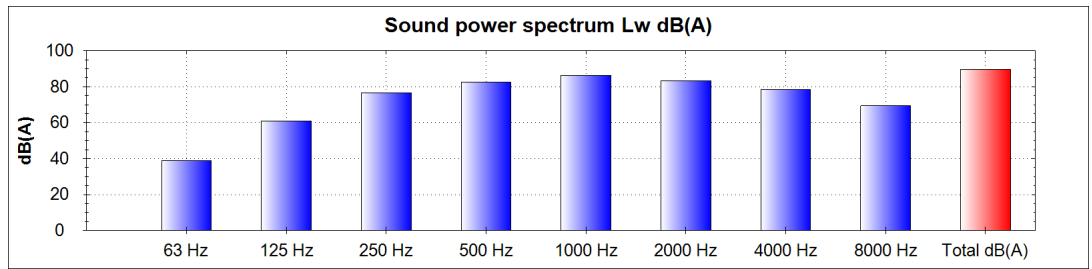

Pressure dB(A) [1,5 m]

63 Hz	24
125 Hz	46
250 Hz	62
500 Hz	68
1000 Hz	72
2000 Hz	69
4000 Hz	64
8000 Hz	55
Total dB(A)	75

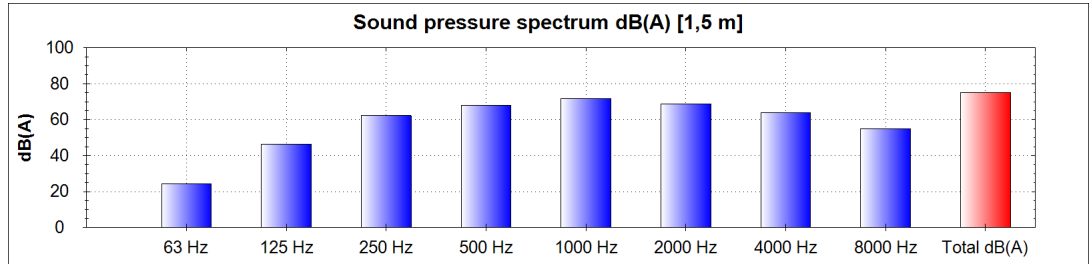

dimensions diagram

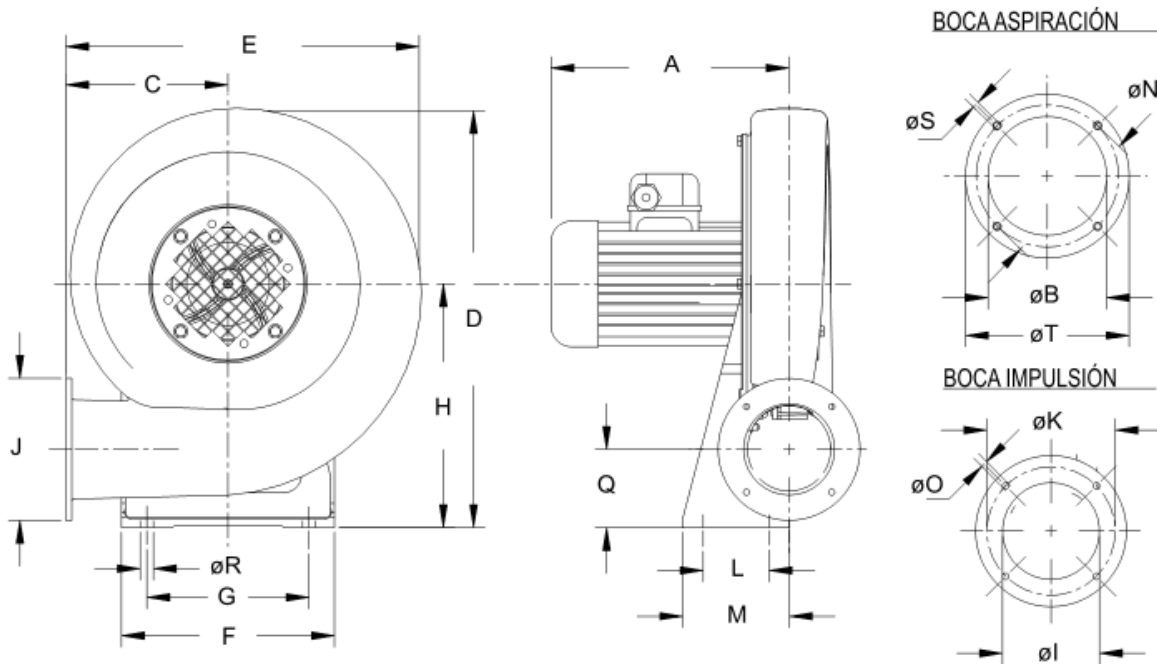

Dimensions (mm)

A=240	BØ=110	C=162	D=413	D1=405	D2=402	D3=519	D4=473	D5=440	D6=431	E=353	F=210
G=160	H=240	IØ=90	J=140	KØ=119	L=65	M=105	NØ=132	OØ=6,2	P=18,5	Q=77	RØ=13
SØ=6	TØ=152	U=460	V=406	W=363	X=353	Y=460	Z=406				

Wiring diagram

