

ÇETİK®
İSİ SANAYİ
Solid, Liquid and Gas Fuel Heating Systems



INVOLVE HEATING OF THE WORLD

CERTIFICATE THAT ARE PRIDE OF US AND QUALITY OF YOURS



Our company, as ÇETİK ISI SANAYİ was established in 1986 year. Our first producing was solar collector. But after times, for the development economic heat solutions , it started to AR-GE (Research and Development) workings. At the 1998 year, taken by from this works positive results and in same year started to producing for Solid Fuel Boiler.

Now, 10.000 m² close area total 13.000 m² factory area and approximately with 100 expert staff, in 1 year 10.000 Boilers are manufacturing. In this context, ÇETİK ISI SANAYİ to be make big investments and with quality policy, to hold up customer pleasure first plan.



As we ÇETİK ISI SANAYİ, our main goal is, representation high technology, strong capital stock, high humane asset and international norm . This manufacturing can be make each one expert and professional team, be use the last technology. Therefore, economic, safety and with patent large product range, to become, request brand in Turkey . Productivity and quality of CE, EN ISO 9001:2000, TSE, UKR-SEPRO, GOST-R certificate and university efficiency with reports proving ÇETİK ISI SANAYİ, cause of high quality production , not limited with our country ; in South America, Australia, Europe, Middle East and Central Asia regions, more than 30 countries exports to the continues every day.

www.cetikisisan.com.tr



Çetik ISI Sanayi, R & D to the importance and ultimate customer satisfaction as a result, all raw materials and parts, the best way to test the use of return on their highest ensure to each product, the smallest detail, even questioning the product quality at maximum level all equipment is required to be used.

With professional approach and institutional culture ,
With management rationale based on the experience and data,
With invest on the technology,
With financial and sector achievement,

Honourable and confidential brand ÇETİK ISI SANAYİ this development will be an assimilate universal...



since

1986

SOLID FUEL BOILER

EKO SERIES

4 PASSING WAYS, BLAZE CRACKING SLICES



HIGH EFFICIENCY

Boilers have %88 efficiency with ergonomics control panel, servo motor hardware, special interior design and water grill system.

USING FACILITY

Through to large feeding cover, filling the fuel and ignition operation can make easily. With easy using control panel, boiler work maximum efficiency and economical type automatically by adjusting the fan speed and boiler temperature adjustment. Thanks to movable and rotary water grill only moving the ash arm empty the ash in to the ashtray.

BURNING CONTROL SYSTEM

After fan and boiler thermostat adjustment, through to adjustable fan speed control, air disperse into the boiler homogeneous. Boiler reach to regime in a shortly time by special interior design. After entering the regime fan stop and boiler burn by natural draught. When the boiler reach the desired temperature, servo motor close fan valve %100 and chimney valve %80 so boiler enter the sleeping mode. Thanks to this system, burning is completely under control and saving economy from fuel and electric consumption.

FUEL SPECIALITIES

Our solid fuel boilers provide to designed, when the burn coal, lignite coal, wood and wood-derived fuels, in a high combustion efficiency and low flue gas emission values.

SOOT CLEANING

Cleaning of our boilers make once or twice a year by special boiler interior design. Cleaning cover is back side of the boiler so this cleaning is easier than other boilers.

HIGH SAFETY

Boiler water temperature can adjust on to the control panel. Also after shut down the electric, servo motor close the fan and chimney valves so that boiler temperature do not rise up. The third safety point is limit thermostat. Limit thermostat shut down the electric system, fan motor and close the servo motor valves when the boiler temperature exceed the 90°C.

AESTHETIC DESIGN

Boiler body is isolated completely for heat losing and also water grill absorb the heat. Boiler outside view is painted with electrostatic paint and this gives the boiler aesthetic view.

ENVIRONMENT FRIEND

Thanks to special interior design, benefit maximum from burning and after burning gases. Also harmful waste gases and chimney temperature increase minimum values.

LONG LIFE AND HIGH QUALITY

Our manufacturing can be made according to acceptable general standards. To be used A1 quality boiler metal sheet, consequently boiler lifetime so long. To be left from producing every boiler, according to 3 bar operating pressure, to be tested with 5 bar hydrostatic pressure. Our boiler is designed as with grill, through to in-circuit water, increase its longevity. And, at the time of boiler burning, to consist of heat on the grill, to turn into beneficial energy. Through the use of gasket covers, to furnish complete imperviousness.



1. Cleaning Cover
2. Fuel Feeding Cover
3. Ash Taking Cover
4. Digital Control Panel
5. Lifting Hook
6. Flame Breaking Slices
7. Chimney
8. Boiler Outlet
9. Boiler Return
10. Safety Outlet
11. Safety Return
12. Safety Ventil Inlet
13. Servo Motor
14. Fan
15. Fan Valve
16. Wag, Roll Arm Of Hydrous Crib
17. Crib Hot Water Tubes

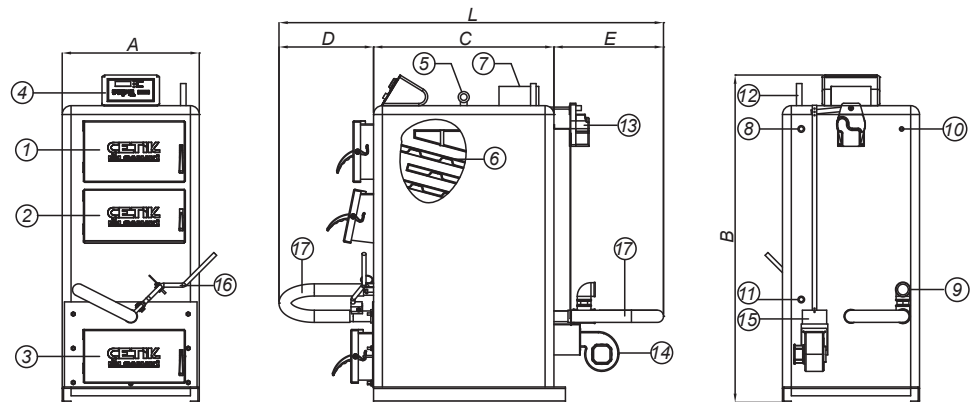

EKO DIGITAL LCD control panel used in 20-30-40-60 series models

TECHNICAL SIZES

MODEL	A mm	B mm	C mm	D mm	E mm	L mm	BOILER		SAFETY		CHIMNEY DIAMETER mm
							OUTLET inch (")	RETURN inch (")	OUTLET inch (")	RETURN inch (")	
EKO-20	580	1220	540	410	460	1410	1	1	3/4	3/4	130
EKO-30	630	1370	590	410	460	1460	1 1/4	1 1/4	3/4	3/4	130
EKO-40	630	1430	690	410	460	1560	1 1/4	1 1/4	3/4	3/4	150
EKO-60	680	1510	840	410	460	1710	1 1/2	1 1/2	3/4	3/4	180
EKO-90	780	1830	1040	410	460	1910	2	2	1	1	200

TECHNICAL FEATURES

		EKO-20	EKO-30	EKO-40	EKO-60	EKO-90
HEATING CAPACITY (Coal 7500 kcal/kg)	kW	23	34	46	69	104
	kcal/h	20,000	30,000	40,000	60,000	90,000
WATER CAPACITY	liter	30	35	45	65	110
WEIGHT	kg	200	250	300	350	650
WORKING PRESSURE (max)	bar	3	3	3	3	3
TEST PRESSURE	bar	5	5	5	5	5
MAXIMUM BOILER OUTLET WATER TEMPERATURE	°C	90	90	90	90	90
ASHTRAY CAPACITY	liter	11	22	26	29	70
NOMINAL VOLTAGE	V	220	220	220	220	220
WORKING FREQUENCY	Hz	50	50	50	50	50
FAN POWER	W	125	125	125	125	180

SOLID FUEL CENTRAL HEATING BOILER

EKO SERIES

4 PASSING WAYS, BLAZE CRACKING SLICES



HIGH EFFICIENCY

Solid fuel central heating boilers have %88 efficiency with ergonomics control panel, servo motor hardware, special interior design and water grill system.

USING FACILITY

Filling the fuel, ignition and taking the ash procedures can make easily thanks to durable and large cover. Thanks to easy using design control panel, fan and boiler temperature can easily adjusted and system temperature can display. In these boilers every kind of solid fuel can burn easily.

BURNING CONTROL SYSTEM

After fan and boiler thermostat adjustment, due to adjustable fan speed control, air disperses in to the boiler homogeneous. Boiler reaches to regime in a shortly time by special interior design. After entering the regime fan stop and boiler burn by natural draught. When the boiler reach the desired temperature, servo motor close fan valve %100 and chimney valve %80 so boiler enter the sleeping mode. Thanks to this system, burning is completely under control and saving economy from fuel and electric consumption.

FUEL SPECIALITIES

Our solid fuel boilers provide to designed, when the burn coal, lignite coal, wood and wood-derived fuels, in a high combustion efficiency and low flue gas emission values.

SOOT CLEANING

Cleaning of the soot, make once a month by special boiler's interior design. Cleaning cover is back side of the boiler so this, cleaning is easier than other boilers.

HIGH SAFETY

Boiler water temperature can adjust on to the control panel. Also after shut down the electric, servo motor close the fan and chimney valves so that boiler temperature do not rise up. The third safety point is limit thermostat. Limit thermostat shut down the electric system, fan motor and close the servo motor valves when the boiler temperature exceed the 90°C.

AESTHETIC DESIGN

Boiler body is isolated completely for heat losing and also water grill absorb the heat. Boiler outside view is painted with electrostatic paint and this gives the boiler aesthetic view.

ENVIRONMENT FRIEND

Through to special interior design, benefit maximum from burning and after burning gases. Also harmful waste gases and chimney temperature decrease minimum values

LONG LIFE AND HIGH QUALITY

Our manufacturing can be made according to acceptable general standards. To be used A1 quality boiler metal sheet, consequently boiler lifetime so long. To be left from producing every boiler, according to 3 bar operating pressure, to be tested with 5 bar hydrostatic pressure. Our boiler is designed as with grill, through to in circuit water, increase its longevity. And, at the time of boiler burning, to consist of heat on the grill, to turn into beneficial energy. Through the use of gasket covers, to furnish complete imperviousness. To be used high isolation refractor concrete at the boiler covers.



1. Cleaning Cover
2. Fuel Feeding Cover
3. Ash Taking Cover
4. Control Panel
5. Lifting Hook
6. Flame Breaking Slices
7. Chimney
8. Boiler Outlet
9. Boiler Return
10. Safety Outlet
11. Safety Return
12. Safety Ventil Inlet
13. Servo Motor
14. Fan
15. Fan Valve

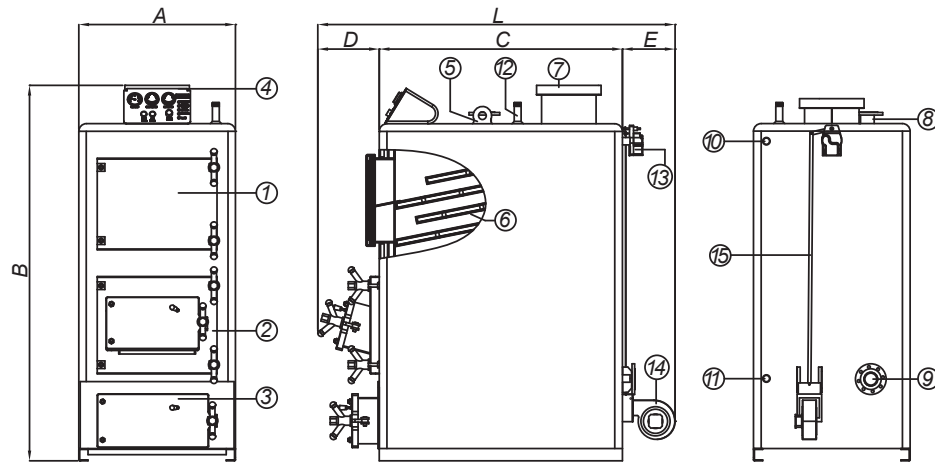

TECHNICAL SIZES

MODEL	A mm	B mm	C mm	D mm	E mm	L mm	BOILER		SAFETY		CHIMNEY DIAMETER mm
							OUTLET mm	RETURN mm	OUTLET inch (")	RETURN inch (")	
EKO-120	850	1845	1290	310	360	1960	65	65	1 1/2	1 1/2	200
EKO-170	950	1895	1495	310	360	2165	80	80	1 1/2	1 1/2	250
EKO-200	1000	1945	1625	310	360	2295	80	80	1 1/2	1 1/2	270
EKO-250	1050	2045	1665	320	380	2365	80	80	1 1/2	1 1/2	350
EKO-300	1230	2265	2055	330	380	2765	80	80	1 1/2	1 1/2	350

TECHNICAL FEATURES

		EKO-120	EKO-170	EKO-200	EKO-250	EKO-300
HEATING CAPACITY (Coal 7500 kcal/kg)	kW	139	197	232	290	348
	kcal/h	120,000	170,000	200,000	250,000	300,000
WATER CAPACITY	liter	150	250	290	385	420
WEIGHT	kg	950	1350	1500	1650	2500
WORKING PRESSURE (max)	bar	3	3	3	3	3
TEST PRESSURE	bar	5	5	5	5	5
MAXIMUM BOILER OUTLET WATER TEMPERATURE	°C	90	90	90	90	90
ASHTRAY CAPACITY	liter	95	107	115	115	115
NOMINAL VOLTAGE	V	220	220	220	220	220
WORKING FREQUENCY	Hz	50	50	50	50	50
FAN POWER	W	180	180	180	180	370

SOLID FUEL CENTRAL HEATING BOILER

EKO SERIES

4 PASSING WAYS, BLAZE CRACKING SLICES



HIGH EFFICIENCY

Solid fuel central heating boilers have %88 efficiency with ergonomics control panel, servo motor hardware, special interior design and water grill system.

USING FACILITY

Filling the fuel, ignition and taking the ash procedures can make easily thanks to durable and large cover. Thanks to easy using design control panel, fan and boiler temperature can easily adjusted and system temperature can display. These boilers can burn easily every kind of solid fuel.

BURNING CONTROL SYSTEM

Fan assembled on the front cover and air circulated in to the boiler homogeneous by adjusting the fan air valves. After adjusting the fan and boiler temperature, boiler reach the regime and fan stop after these position burning continue by natural draught. If the temperature reach the desired degree, servo motor close the chimney valves about %80 and control the natural draught.

FUEL SPECIALITIES

Our solid fuel boilers provide to designed, when the burn coal, lignite coal, wood and wood-derived fuels, in a high combustion efficiency and low flue gas emission values.

SOOT CLEANING

Cleaning of the soot, make once a month by special boiler's interior design. Cleaning cover is back side of the boiler so this, cleaning is easier than other boilers.

HIGH SAFETY

Boiler water temperature can adjust on to the control panel. Also after shut down the electric, servo motor close the fan and chimney valves so that boiler temperature do not rise up. The third safety point is limit thermostat. Limit thermostat shut down the electric system, fan motor and close the servo motor valves when the boiler temperature exceed the 90°C.

AESTHETIC DESIGN

Boiler body is isolated completely for heat losing and also water grill absorb the heat. Boiler outside view is painted with electrostatic paint and this gives the boiler aesthetic view.

ENVIRONMENT FRIEND

Through to special interior design, benefit maximum from burning and after burning gases. Also harmful waste gases and chimney temperature decrease minimum values.

LONG LIFE AND HIGH QUALITY

Our manufacturing can be made according to acceptable general standards. To be use A1 quality boiler metal sheet, consequently boiler lifetime so long. To be leave from producing every boiler, according to 3 bar operating pressure, to be test with 5 bar hydrostatic pressure. Our boiler make disagn as with grill, through to in circuit water, increase its longevity. And, at the time of boiler burning, to consist of heat on the grill, to turn into beneficial energy. Through the using gasket covers, to furnish complete imperviousness. To be used high isolation over the 1.000 centigrade degree,durable of the high temperature refractor concrete at the boiler covers.



1. Front Cover
2. Fuel Feeding Cover
3. Ash Taking Cover
4. Control Panel
5. Lifting Hook
6. Flame Breaking Slices
7. Chimney
8. Boiler Outlet
9. Boiler Return
10. Safety Outlet
11. Safety Return
12. Servo Motor
13. Cleaning Cover
14. Fan

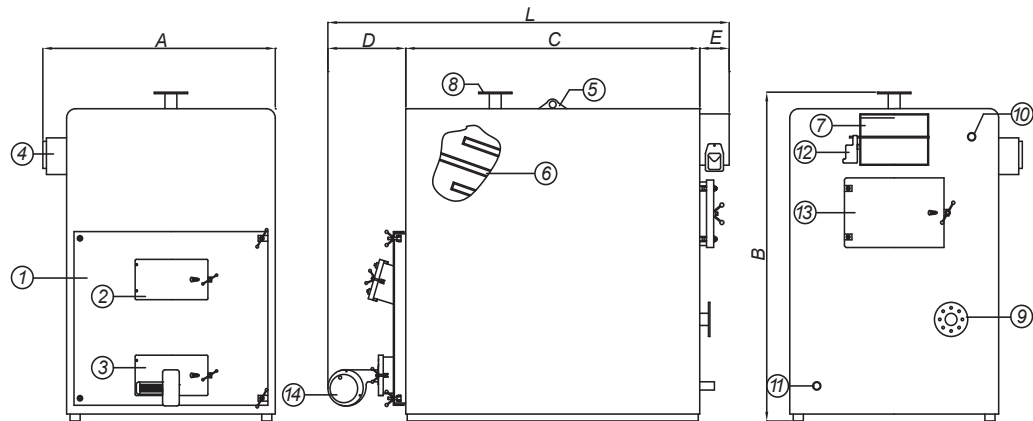

TECHNICAL SIZES

MODEL	A	B	C	D	E	L	BOILER		SAFETY		CHIMNEY DIAMETER
							OUTLET	RETURN	OUTLET	RETURN	
							mm	mm	inch (")	inch (")	
EKO-350	1400	2050	1970	600	240	2810	100	100	1 1/2	1 1/2	300 x 450
EKO-400	1450	2100	2070	600	240	2910	100	100	1 1/2	1 1/2	320 x 450
EKO-450	1520	2200	2120	600	240	2960	100	100	1 1/2	1 1/2	320 x 450
EKO-500	1570	2300	2170	600	240	3010	100	100	1 1/2	1 1/2	350 x 450
EKO-600	1670	2450	2270	600	240	3110	125	125	2	2	350 x 480
EKO-800	1770	2700	2470	600	240	3310	150	150	2	2	350 x 480
EKO-1000	1920	2950	2670	600	240	3510	150	150	2	2	400 x 450

TECHNICAL FEATURES

		EKO-350	EKO-400	EKO-450	EKO-500	EKO-600	EKO-800	EKO-1000
HEATING CAPACITY (Coal 7500 kcal/kg)	kW	406	465	523	581	697	930	1,162
	kcal/h	350,000	400,000	450,000	500,000	600,000	800,000	1,000,000
WATER CAPACITY	liter	480	530	600	700	850	1100	1350
WEIGHT	kg	3400	3700	4,000	4300	4,800	6000	7250
WORKING PRESSURE (max)	bar	3	3	3	3	3	3	3
TEST PRESSURE	bar	5	5	5	5	5	5	5
MAX. BOILER OUTLET WATER TEMPERATURE	°C	90	90	90	90	90	90	90
NOMINAL VOLTAGE	V	220	220	220	220	220	220	220
WORKING FREQUENCY	Hz	50	50	50	50	50	50	50
FAN POWER	W	550	550	750	750	750	750	750

SOLID FUEL BOILER

EKO B SERIES

3 PASSING WAYS, TUBULAR AND BLAZE CRACKING SLICES



HIGH EFFICIENCY

Ergonomic control panel, boiler tubes and fire the offensive zone, it has got high efficiency, together produced a special internal design and with water grill system.

USING FACILITY

Through to large feeding cover, filling the fuel and ignition operation can make easily. With easy using control panel, boiler work maximum efficiency and economical type automatically by adjusting the fan speed and boiler temperature adjustment. Thanks to movable and rotary water grill only moving the ash arm empty the ash in to the ashtray.

BURNING CONTROL SYSTEM

Combustion chamber is capable daily capacity. After fan and boiler thermostat adjustment, through to adjustable fan speed control, air disperse into the boiler homogeneous. Boiler reach to regime in a shortly time by special interior design. After entering the regime fan stop and boiler burn by natural draught. When the boiler reach the desired temperature, servo motor close fan valve %100 and chimney valve %80 so boiler enter the sleeping mode. Thanks to this system, burning is completely under control and saving economy from fuel and electric consumption.

FUEL SPECIALITIES

Our solid fuel boilers provide to designed, when the burn coal, lignite coal, wood and wood-derived fuels, in a high combustion efficiency and low flue gas emission values.

AESTHETIC DESIGN

Boiler body is isolated completely for heat losing and also water grill absorb the heat. Boiler outside view is painted with electrostatic paint and this gives the boiler aesthetic view.

ENVIRONMENT FRIEND

Thanks to special interior design, benefit maximum from burning and after burning gases. Also harmful waste gases and chimney temperature increase minimum values.

LONG LIFE AND HIGH QUALITY

Our manufacturing can be made according to acceptable general standards. To be use A1 quality boiler metal sheet, consequently boiler lifetime so long. To be leave from producing every boiler, according to 3 bar operating pressure, to be test with 5 bar hydrostatic pressure. Our boiler make disagn as with grill, through to in circuit water, increase its longevity. And, at the time of boiler burning, to consist of heat on the grill, to turn into beneficial energy. Through the using gasket covers, to furnish complete imperviousness.



1. Cleaning Cover
2. Fuel Feeding Cover
3. Ash Taking Cover
4. Digital Control Panel
5. Lifting Hook
6. Flame Breaking Slices
7. Fume Pipes
8. Chimney
9. Fume Chest
10. Fume Chest Cleaning Cover
11. Chimney
12. Boiler Outlet
13. Boiler Return
14. Safety Outlet
15. Safety Return
16. Safety Ventil Inlet
17. Fan
18. Wag, Roll Arm Of Hydrous Crib
19. Crib Hot Water Tubes

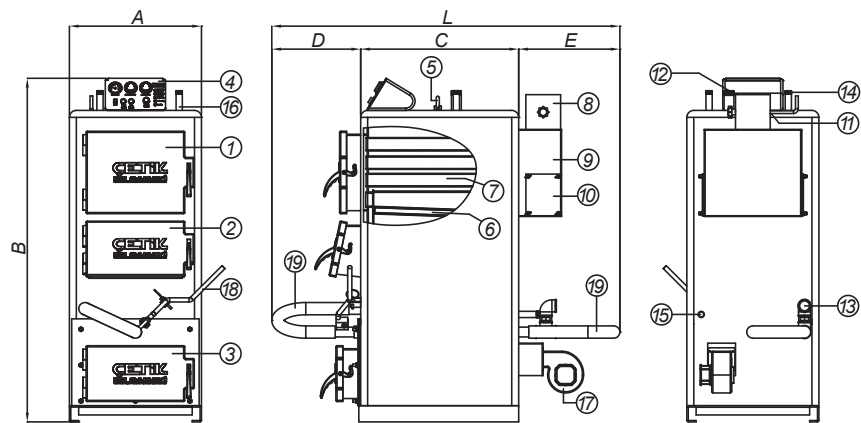

EKO DIGITAL LCD control panel used in 20-30-40-60 series models

TECHNICAL SIZES											
MODEL	A	D	C	E	L	B	BOILER		SAFETY		CHIMNEY DIAMETER
	mm	mm	mm	mm	mm	mm	OUTLET inch (")	RETURN inch (")	OUTLET inch (")	RETURN inch (")	mm
EKO B- 20	520	400	535	430	1365	1285	1	1	3/4	3/4	130
EKO B- 30	575	400	585	430	1415	1450	1 1/4	1 1/4	3/4	3/4	130
EKO B- 40	575	450	685	500	1635	1500	1 1/4	1 1/4	3/4	3/4	150
EKO B- 60	625	540	835	560	1935	1595	1 1/2	1 1/2	1	1	180
EKO B- 80	735	540	1070	560	2170	1770	2	2	1	1	200
EKO B- 100	850	360	1220	450	2030	1910	2	2	1	1	200
EKO B- 125	900	360	1320	450	2130	1910	Ø65	Ø65	1 1/2	1 1/2	200

TECHNICAL FEATURES								
		EKO B - 20	EKO B - 30	EKO B - 40	EKO B - 60	EKO B - 80	EKO B - 100	EKO B - 125
HEATING CAPACITY (Coal 7500 kcal/kg)	kW	23	34	46	69	93	116	145
	kcal/h	20,000	30,000	40,000	60,000	80,000	100,000	125,000
WATER CAPACITY	liter	60	85	120	195	255	295	325
WEIGHT	kg	238	296	348	455	690	785	910
WORKING PRESSURE (max)	bar	3	3	3	3	3	3	3
TEST PRESSURE	bar	5	5	5	5	5	5	5
MAX. BOILER OUTLET WATER TEMPERATURE	°C	90	90	90	90	90	90	90
ASHTRAY CAPACITY	liter	10	13	15	21	28	35	44
NOMINAL VOLTAGE	V	220	220	220	220	220	220	220
WORKING FREQUENCY	Hz	50	50	50	50	50	50	50
FAN POWER	W	125	125	125	125	180	180	180

SOLID FUEL CENTRAL HEATING BOILER

EKO KB SERIES

FUME TUBULAR, RADIATION STYLE



HIGH EFFICIENCY

EKO KB series of solid fuel boilers ergonomic control panel, designed on the basis of the combustion pressure inside the structure and water gridded system works with high efficiency. Turbulators smoke pipe is placed on heat combustion caused by preventing the mast from the shaft to increase the efficiency of the boiler.

USING FACILITY

Filling the fuel, ignition and taking the ash procedures can make easily thanks to durable and large cover. Thanks to easy using design control panel, fan and boiler temperature can easily adjusted and system temperature can display.

BURNING CONTROL SYSTEM

Fan assembled on the front cover and air circulated in to the boiler homogeneous by adjusting the fan air valves. After setting the temperature of the boiler, boiler reaches the required temperature, the combustion fan control is disabled and burning is kept under the control.

FUEL SPECIALITIES

EKO KB series of solid fuel boilers, coal, lignite coal, wood and wood-derived fuels when burned in a high combustion efficiency and low flue gas emissions, is designed to provide. Cover and grill won the renovations can be converted into liquid and gaseous fuels. In this way, conversion gain of approximately 50% increase in capacity allows.

AESTHETIC DESIGN

Boiler body is isolated completely for heat losing. Boiler outside view is painted with electrostatic paint and this gives the boiler aesthetic view.

ENVIRONMENT FRIEND

Through to special interior design, benefit maximum from burning and after burning gases. Also harmful waste gases and chimney temperature decrease minimum values.

LONG LIFE AND HIGH QUALITY

Our manufacturing can be made according to acceptable general standards. To be use A1 quality boiler metal sheet, consequently boiler lifetime so long. To be leave from producing every boiler, according to

3 bar operating pressure, to be test with 5 bar hydrostatic pressure. Our boiler make disagn as with grill, through to in circuit water, increase its longevity. And, at the time of boiler burning, to consist of heat on the grill, to turn into beneficial energy. Through the using gasket covers, to furnish complete imperviousness. To be used high isolation over the 1.000 centigrade degree, durable of the high temperature refractor concrete at the boiler covers.



- 1 Front Cover
- 2 Fuel Feeding Cover
- 3 Ash Taking Cover
- 4 Control Panel
- 5 Fan
- 6 Boiler Outlet
- 7 Safety Outlet
- 8 Lifting Hook
- 9 Boiler Return
- 10 Safety Return
- 11 Fume Chest
- 12 Chimney
- 13 Manuel Chimney Tab
- 14 Balst Cover
- 15 Water Grill Outlet
- 16 Water Grill Return
- 17 Filling-Discharging

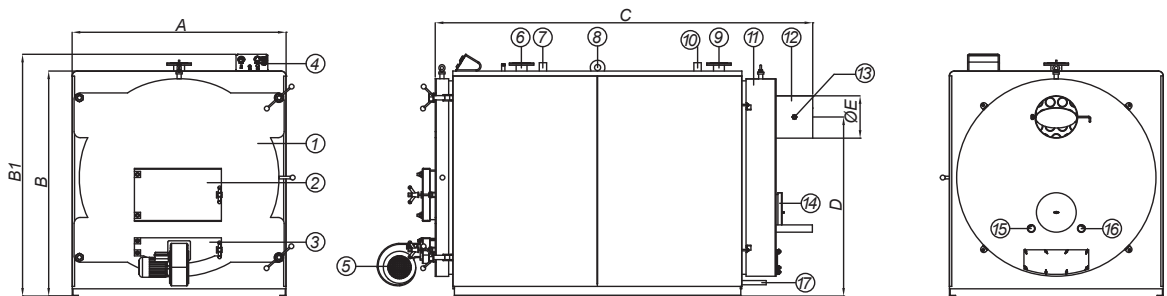

TECHNICAL SIZES

MODEL	CAPACITY		A	B	B1	C	D	E (Ø)	BOILER		SAFETY		BOILER FILLING DISCHARGE	WEIGHT	WATER CAPACITY
	kcal/h	kW							OUTLET	RETURN	OUTLET	RETURN			
			mm	mm	mm	mm	mm	mm	mm	mm	inch (")	inch (")	inch (")	kg	lt
EKO KB-150	150,000	174	1180	1290	1425	2205	990	250	65	65	1 1/4	1 1/4	3/4	1380	900
EKO KB-175	175,000	203	1230	1370	1510	2325	1020	250	65	65	1 1/4	1 1/4	3/4	1600	1200
EKO KB-200	200,000	233	1300	1440	1580	2365	1075	300	65	65	1 1/2	1 1/2	3/4	1870	1350
EKO KB-250	250,000	291	1340	1450	1590	2605	1105	300	80	80	1 1/2	1 1/2	3/4	2080	1470
EKO KB-300	300,000	349	1440	1550	1690	2845	1195	300	80	80	1 1/2	1 1/2	3/4	2670	2020
EKO KB-350	350,000	407	1500	1610	1750	2875	1260	300	80	80	1 1/2	1 1/2	3/4	3090	2080
EKO KB-400	400,000	465	1600	1710	1850	2935	1360	300	80	80	1 1/2	1 1/2	3/4	3330	2300
EKO KB-450	450,000	523	1660	1770	1910	3050	1395	350	100	100	1 1/2	1 1/2	3/4	3610	2570
EKO KB-500	500,000	581	1720	1830	1970	3050	1455	350	100	100	1 1/2	1 1/2	3/4	3730	2450
EKO KB-600	600,000	698	1750	1860	2000	3090	1480	350	125	125	2	2	3/4	4230	2690
EKO KB-700	700,000	814	1860	2000	2140	3140	1620	350	125	125	2	2	3/4	4810	3200
EKO KB-800	800,000	930	1960	2100	2240	3275	1670	400	125	125	2 1/2	2 1/2	3/4	5300	3500

SOLID FUEL-AUTOMATIC FEEDING BOILER

EKO S SERIES

4 PASSING WAYS, BLAZE CRACKING SLICES



HIGH EFFICIENCY

Boilers have %88 efficiency with high sensitive digital control panel and special interior design. Also fuel feeding is under the combustion chamber so boiler efficiency is higher and waste materials are less than others.

USING FACILITY

Through large bunker capacity, user fills the bunker and approximately don't fill three days. Thanks to feeding cover, reaching the combustion chamber and the ignition operation can make easily. As optional if you prefer automatic ignition, you will get out from the first burning bother. User can easily and clearly see all adjustment details from LCD display on to the digital control panel. Boiler works high efficient and economically after setting adjustment by high sensitive digital control panel. You can take necessary ash, from the boiler under here place, from ashtray.

BURNING CONTROL SYSTEM

Boiler-circulation pump working temperature, fuel loading-delay time adjustment and fan speed control can easily adjust by digital control panel and after this air disperse in to the boiler homogeneous. Boiler reaches to regime in a shortly time. Fan and reducer switch off and boiler stay sleeping mode after entering the adjusted boiler temperature. Fuel loading and waiting (delay) time can easily adjust by user according to air conditions and building positions. Adjusting time's flow chart and working position can display on LCD screen. Fuel is loading by spiral in to the combustion chamber from below so that fire never burn out.

FUEL SPECIALITIES

Our solid fuel boilers provide to designed, when the burn hazelnut coal, pellet, prina, fruit stones and hazelnut coal, in a high combustion efficiency and low flue gas emission values.

SOOT CLEANING

Ash cleaning is more lower doing according to other sample boilers. Cleaning cover is back side of the boiler so this, cleaning is easier than other boilers.

HIGH SAFETY

Boiler water temperature can adjust on to the digital control panel. Limit thermostat shut down the reducer and fan when the boiler temperature exceeds the 90°C but circulation pump continues to work. Circulation pump working temperature can adjust between 10°C and 45°C. If water temperature fall down +4°C, circulation pump work automatically for blocking the freezing risk. No any firing from the combustion chamber to the bunker, thanks to gear protect system and with water grill system.

AESTHETIC DESIGN

Control panel is adaptation with boiler body completely thanks to panel's special design. Boiler body is isolated completely for heat losing and also water grill absorb the heat. Boiler outside view is painted with electrostatic paint and this gives the boiler aesthetic view.

ENVIRONMENT FRIEND

Due to special interior design and sensitive working digital control panel, benefit maximum from burning and after burning gases. Also harmful waste gases and chimney temperature decrease minimum values.

LONG LIFE AND HIGH QUALITY

Our manufacturing can be made according to acceptable general standards. To be use A1 quality boiler metal sheet, consequently boiler lifetime so long. To be leave from producing every boiler, according to 3 bar operating pressure, to be test with 5 bar hydrostatic pressure. Through the using gasket covers, to furnish complete imperviousness.



- 1 Cleaning Cover
- 2 Fuel Feeding Cover
- 3 Ash Taking Cover
- 4 Digital Control Panel
- 5 Lifting Hook
- 6 Flame Breaking Slices
- 7 Chimney
- 8 Boiler Outlet
- 9 Boiler Return
- 10 Safety Outlet
- 11 Safety Return
- 12 Safety Ventil Inlet
- 13 Reducer Motor
- 14 Spiral
- 15 Fan
- 16 Bunker
- 17 With Water Safety System
- 18 Gear Safety System
- 19 Automatic Ignition

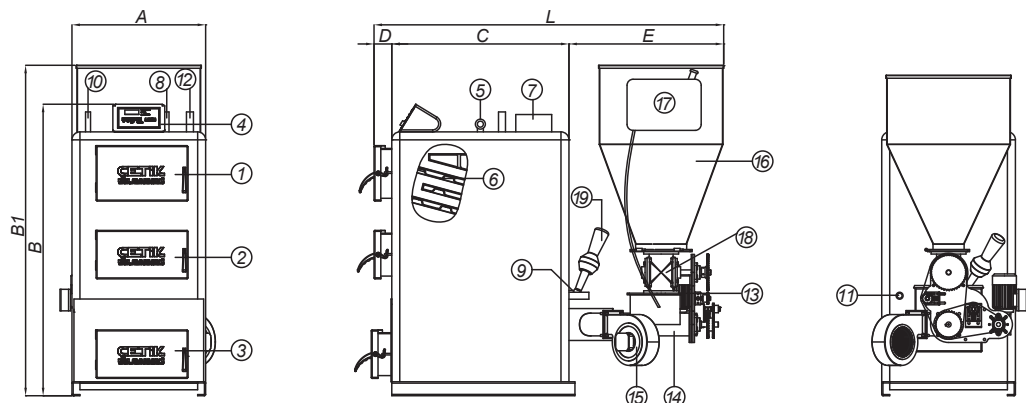

TECHNICAL SIZES

MODEL	A	B	B1	C	D	E	L	BOILER		SAFETY		CHIMNEY DIAMETER
								OUTLET	RETURN	OUTLET	RETURN	
								mm	mm	mm	mm	mm
EKO S-20	580	1230	1470	540	170	660	1370	1	1	3/4	3/4	130
EKO S-30	630	1380	1620	590	180	780	1550	1	1	3/4	3/4	130
EKO S-40	630	1440	1670	695	180	780	1650	1 1/4	1 1/4	3/4	3/4	150
EKO S-60	730	1500	1770	895	180	855	1950	1 1/2	1 1/2	3/4	3/4	180
EKO S-90	785	1770	2010	1045	200	800	2045	2	2	1 1/2	1 1/2	200

TECHNICAL FEATURES

		EKO S-20	EKO S-30	EKO S-40	EKO S-60	EKO S-90
HEATING CAPACITY (Coal 7500 kcal/kg)	kW	23	34	46	69	104
	kcal/h	20,000	30,000	40,000	60,000	90,000
WATER CAPACITY	liter	30	35	45	65	110
WEIGHT	kg	300	400	450	500	900
WORKING PRESSURE (max)	bar	3	3	3	3	3
TEST PRESSURE	bar	5	5	5	5	5
MAX. BOILER OUTLET WATER TEMPERATURE	°C	90	90	90	90	90
BUNKER FUEL CAPACITY	kg	100	100	125	175	225
ASHTRAY CAPACITY	liter	11	22	26	29	70
NOMINAL VOLTAGE	V	220	220	220	220	220
WORKING FREQUENCY	Hz	50	50	50	50	50
REDUCER MOTOR POWER	W	250	250	250	250	250
FAN POWER	W	180	180	180	180	180

FUEL TYPE

Hazelnut Coal, Pellet, Prina, Fruit Stones

SOLID FUEL-AUTOMATIC FEEDING CENTRAL HEATING BOILER

EKO S SERIES

4 PASSING WAYS, BLAZE CRACKING SLICES



HIGH EFFICIENCY

Boilers have %88 efficiency with high sensitive digital control panel and special interior design. Also fuel feeding is under the combustion chamber so boiler efficiency is higher and waste materials are less than others.

USING FACILITY

Through large bunker capacity, user fills the bunker and approximately don't fill three days. Thanks to feeding cover, reaching the combustion chamber and the ignition operation can make easily. As optional if you prefer automatic ignition, you will get out from the first burning boiler. Combustion chamber covered by refracter concrete and this is increasing the temperature around this area. User can easily and clearly see all adjustment details from LCD display on to the digital control panel. Boiler works high efficient and economically after setting adjustment by high sensitive digital control panel. User can take the ash from combustion chamber in to the ashtray.

BURNING CONTROL SYSTEM

Boiler-circulation pump working temperature, fuel loading-delay time adjustment and fan speed control can easily adjust by digital control panel and after this air disperse in to the boiler homogeneous. Boiler reaches to regime in a shortly time. Fan and reducer switch off and boiler stay sleeping mode after entering the adjusted boiler temperature. Fuel loading and waiting (delay) time can easily adjust by user according to air conditions and building positions. Adjusting time's flow chart and working position can display on LCD screen. Fuel loading by spiral in to the combustion chamber from below so that fire never burn out.

FUEL SPECIALITIES

Our solid fuel boilers provide to designed, when the burn hazelnut coal, pellet, prina, fruit stones and hazelnut coal, in a high combustion efficiency and low flue gas emission values.

HIGH SAFETY

Boiler water temperature can adjust on to the digital control panel. Limit thermostat shut down the reducer and fan when the boiler temperature exceeds the 90°C but circulation pump continues to work. Circulation pump working temperature can adjust between 10°C and 45°C. If water temperature fall down +4°C, circulation pump work automatically for blocking the freezing risk. No any firing from the combustion chamber to the bunker, thanks to gear protect system and with water grill system.

AESTHETIC DESIGN

Control panel is adaptation with boiler body completely thanks to panel's special design. Boiler body is isolated completely for heat losing and also water grill absorb the heat. Boiler outside view is painted with electrostatic paint and this gives the boiler aesthetic view.

ENVIRONMENT FRIEND

Due to special interior design and sensitive working digital control panel, benefit maximum from burning and after burning gases. Also harmful waste gases and chimney temperature decrease minimum values.

LONG LIFE AND HIGH QUALITY

Our manufacturing can be made according to acceptable general standards. To be used A1 quality boiler metal sheet, consequently boiler lifetime so long. To be left from producing every boiler, according to 3 bar operating pressure, to be tested with 5 bar hydrostatic pressure. Through the use of gasket covers, to furnish complete imperviousness. To be used high isolation over the 1.000 centigrade degree, durable of the high temperature refractory concrete at the boiler covers.



- 1 Cleaning Cover
- 2 Fuel Feeding Cover
- 3 Ash Taking Cover
- 4 Digital Control Panel
- 5 Lifting Hook
- 6 Flame Breaking Slices
- 7 Chimney
- 8 Boiler Outlet
- 9 Boiler Return
- 10 Safety Outlet
- 11 Safety Return
- 12 Safety Ventil Inlet
- 13 Reducer
- 14 Spiral
- 15 Fan
- 16 Bunker
- 17 With Water Safety System
- 18 Gear Safety System
- 19 Automatic Ignition

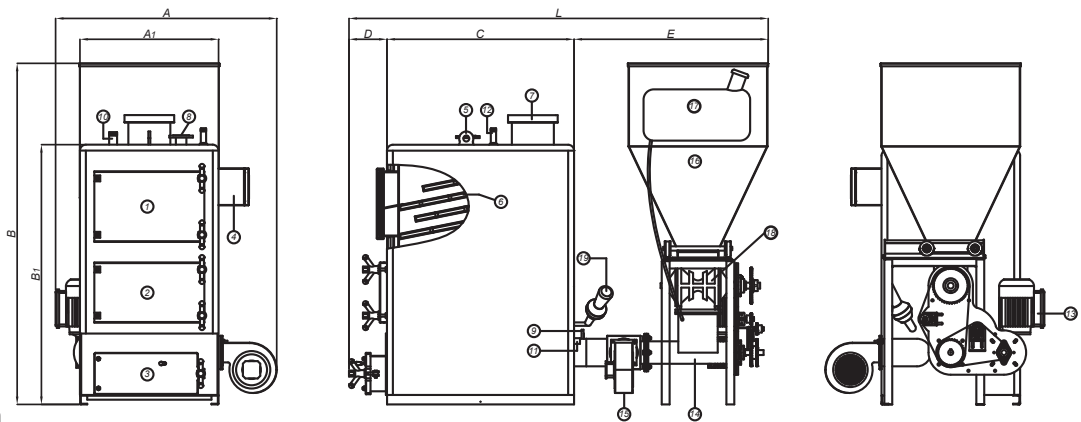

TECHNICAL SIZES

MODEL	A	A1	B	B1	C	D	E	L	BOILER		SAFETY		CHIMNEY DIAMETER mm
	mm	mm	mm	mm	mm	mm	mm	mm	OUTLET mm	RETURN mm	OUTLET inch (")	RETURN inch (")	
EKO S-120	850	1150	1845	2095	1290	200	800	2290	65	65	1 1/2	1 1/2	200
EKO S-170	950	1250	1895	2215	1495	200	1000	2695	80	80	1 1/2	1 1/2	250
EKO S-200	1000	1300	1945	2265	1625	200	1000	2825	80	80	1 1/2	1 1/2	270
EKO S-250	1050	1350	2045	2315	1665	200	1000	2865	80	80	1 1/2	1 1/2	350
EKO S-300	1230	1530	2265	2485	2055	200	1500	3755	80	80	1 1/2	1 1/2	350

TECHNICAL FEATURES

		EKO S-120	EKO S-170	EKO S-200	EKO S-250	EKO S-300
HEATING CAPACITY (Coal 7500 kcal/kg)	kW	139	197	232	290	348
	kcal/h	120,000	170,000	200,000	250,000	300,000
WATER CAPACITY	liter	150	210	290	330	375
WEIGHT	kg	1200	1650	1800	1900	2050
WORKING PRESSURE (max)	bar	3	3	3	3	3
TEST PRESSURE	bar	5	5	5	5	5
MAX. BOILER OUTLET WATER TEMPERATURE	°C	90	90	90	90	90
BUNKER FUEL CAPACITY	kg	300	425	500	500	500
ASHTRAY CAPACITY	liter	95	107	115	115	115
CONSUMPTION WORKING	W	2050	2250	2250	2250	2250
NOMINAL VOLTAGE	V	220	220	220	220	220
WORKING FREQUENCY	Hz	50	50	50	50	50
REDUCER MOTOR POWER	W	1500	1500	1500	1500	1500
FAN POWER	W	550	750	750	750	750
FUEL TYPE	Hazelnut Coal, Pellet, Prina, Fruit Stones					

SOLID FUEL-AUTOMATIC FEEDING CENTRAL HEATING BOILER

EKO S SERIES

4 PASSING WAYS, BLAZE CRACKING SLICES



HIGH EFFICIENCY

Boilers have %88 efficiency with high sensitive digital control panel and special interior design. Also fuel feeding is under the combustion chamber so boiler efficiency is higher and waste materials are less than others.

USING FACILITY

Through large bunker capacity, user fills the bunker and approximately don't fill three days. Thanks to feeding cover, reaching the combustion chamber and the ignition operation can make easily. As optional if you prefer automatic ignition, you will get out from the first burning bother. Combustion chamber covered by refractor concrete and this is increasing the temperature around this area. User can easily and clearly see all adjustment details from LCD display on to the digital control panel. Boiler works high efficient and economically after setting adjustment by high sensitive digital control panel. User can take the ash from combustion chamber in to the ashtray.

BURNING CONTROL SYSTEM

Boiler-circulation pump working temperature, fuel loading-delay time adjustment and fan speed control can easily adjust by digital control panel and after this air disperse in to the boiler homogeneous. Boiler reaches to regime in a shortly time. Fan and reducer switch off and boiler stay sleeping mode after entering the adjusted boiler temperature. Fuel loading and waiting (delay) time can easily adjust by user according to air conditions and building positions. Adjusting time's flow chart and working position can display on LCD screen. Fuel is loading by spiral in to the combustion chamber from below so that fire never burn out.

FUEL SPECIALITIES

Our solid fuel boilers provide to designed,when the burn hazelnut coal, pellet, prina, fruit stones and hazelnut coal, in a high combustion efficiency and low flue gas emission values.

HIGH SAFETY

Boiler water temperature can adjust on to the digital control panel. Limit thermostat shut down the reducer and fan when the boiler temperature exceeds the 90°C but circulation pump continues to work. Circulation pump working temperature can adjust between 10°C and 45°C. If water temperature fall down +4°C, circulation pump work automatically for blocking the freezing risk. No any firing from the combustion chamber to the bunker, thanks to gear protect system and with water grill system.

AESTHETIC DESIGN

Control panel is adaptation with boiler body completely thanks to panel's special design. Boiler body is isolated completely for heat losing and also water grill absorb the heat. Boiler outside view is painted with electrostatic paint and this gives the boiler aesthetic view.

ENVIRONMENT FRIEND

Due to special interior design and sensitive working digital control panel, benefit maximum from burning and after burning gases. Also harmful waste gases and chimney temperature decrease minimum values.

LONG LIFE AND HIGH QUALITY

Our manufacturing can be made according to acceptable general standards. To be used A1 quality boiler metal sheet, consequently boiler lifetime so long. To be left from producing every boiler, according to 3 bar operating pressure, to be tested with 5 bar hydrostatic pressure. Through the use of gasket covers, to furnish complete imperviousness. To be used high isolation over the 1.000 centigrade degree, durable of the high temperature refractory concrete at the boiler covers.



- 1 Cleaning Cover
- 2 Fuel Feeding Cover
- 3 Ash Taking Cover
- 4 Digital Control Panel
- 5 Lifting Hook
- 6 Flame Breaking Slices
- 7 Chimney
- 8 Boiler Outlet
- 9 Boiler Return
- 10 Safety Outlet
- 11 Safety Return
- 12 Bunker
- 13 Reducer
- 14 Spiral
- 15 Fan
- 16 With Water Safety System
- 17 Gear Safety System

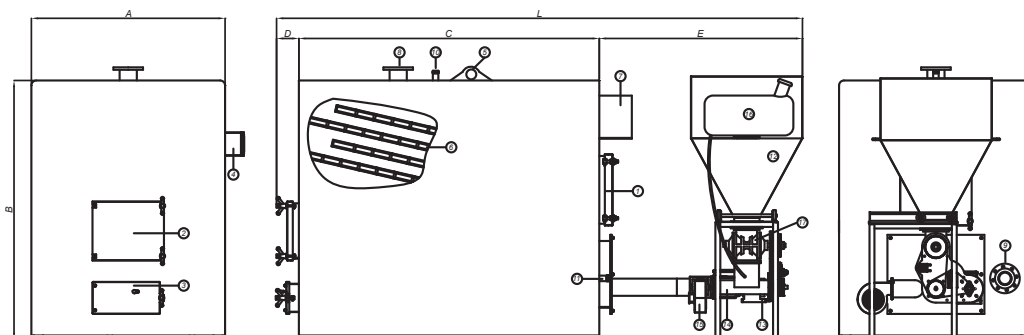

TECHNICAL SIZES

MODEL	A	A1	B	B1	C	D	E	L	BOILER		SAFETY		CHIMNEY DIAMETER mm
	mm	mm	mm	mm	mm	mm	mm	mm	OUTLET mm	RETURN mm	OUTLET inch (")	RETURN inch (")	
EKO S-350	1250	1550	1950	2100	1970	200	1500	3670	100	100	1 1/2	1 1/2	300 x 450
EKO S-400	1300	1600	2000	2150	2070	200	1500	3770	100	100	1 1/2	1 1/2	320 x 450
EKO S-450	1370	1670	2100	2250	2120	200	1500	3820	100	100	1 1/2	1 1/2	320 x 450
EKO S-500	1420	1720	2200	2350	2170	200	1500	3870	100	100	1 1/2	1 1/2	350 x 450
EKO S-600	1520	1820	2350	2500	2270	200	1500	3970	125	125	2	2	350 x 480
EKO S-800	1620	1920	2600	2750	2470	200	1500	4170	150	150	2	2	350 x 480
EKO S-1000	1670	1970	2850	3000	2670	200	1500	4370	150	150	2	2	400 x 450

TECHNICAL FEATURES

		EKO S-350	EKO S-400	EKO S-450	EKO S-500	EKO S-600	EKO S-800	EKO S-1000
HEATING CAPACITY (Coal 7500 kcal/kg)	kW	406	465	523	581	697	930	1,162
	kcal/h	350,000	400,000	450,000	500,000	600,000	800,000	1,000,000
WATER CAPACITY	liter	480	530	600	700	850	1100	1350
WEIGHT	kg	3650	3950	4,300	4600	5,150	6450	7800
WORKING PRESSURE (max)	bar	3	3	3	3	3	3	3
TEST PRESSURE	bar	5	5	5	5	5	5	5
MAX. BOILER OUTLET WATER TEMPERATURE	°C	90	90	90	90	90	90	90
BUNKER FUEL CAPACITY	kg	500	500	500	500	500	500	500
CONSUMPTION WORKING	W	3750	3750	3750	3750	3750	3750	3750
NOMINAL VOLTAGE	V	220	220	220	220	220	220	220
WORKING FREQUENCY	Hz	50	50	50	50	50	50	50
REDUCER MOTOR POWER	W	1500	1500	1500	1500	1500	1500	1500
FUEL TYPE	Hazelnut Coal, Pellet, Prina, Fruit Stones							

SOLID FUEL-AUTOMATIC FEEDING BOILER

EKO BS SERIES

3 PASSING WAYS, TUBULAR AND BLAZE CRACKING SLICES



HIGH EFFICIENCY

Ergonomic control panel, boiler tubes and fire the offensive zone, together produced a special pot for interior design and combustion system has high efficiency.

USING FACILITY

Through large bunker capacity, user fills the bunker and approximately don't fill three days. Thanks to feeding cover, reaching the combustion chamber and the ignition operation can make easily. As optional if you prefer automatic ignition, you will get out from the first burning bother. User can easily and clearly see all adjustment details from LCD display on to the digital control panel. Boiler works high efficient and economically after setting adjustment by high sensitive digital control panel. You can take necessary ash, from the boiler under here place, from ashtray.

BURNING CONTROL SYSTEM

Boiler-circulation pump working temperature, fuel loading-delay time adjustment and fan speed control can easily adjust by digital control panel and after this air disperse in to the boiler homogeneous. Boiler reaches to regime in a shortly time. Fan and reducer switch off and boiler stay sleeping mode after entering the adjusted boiler temperature. Fuel loading and waiting (delay) time can easily adjust by user according to air conditions and building positions. Adjusting time's flow chart and working position can display on LCD screen. Fuel is loading by spiral in to the combustion chamber from below so that fire never burn out.

FUEL SPECIALITIES

Our solid fuel boilers provide to designed, when the burn hazelnut coal, pellet, prina, fruit stones and hazelnut coal, in a high combustion efficiency and low flue gas emission values.

HIGH SAFETY

Boiler water temperature can adjust on to the digital control panel. Limit thermostat shut down the reducer and fan when the boiler temperature exceeds the 90°C but circulation pump continues to work. Circulation pump working temperature can adjust between 10°C and 45°C. If water temperature fall down +4°C, circulation pump work automatically for blocking the freezing risk. No any firing from the combustion chamber to the bunker, thanks to gear protect system and with water grill system.

AESTHETIC DESIGN

Control panel is adaptation with boiler body completely thanks to panel's special design. Boiler body is isolated completely for heat losing and also water grill absorb the heat. Boiler outside view is painted with electrostatic paint and this gives the boiler aesthetic view.

ENVIRONMENT FRIEND

Due to special interior design and sensitive working digital control panel, benefit maximum from burning and after burning gases. Also harmful waste gases and chimney temperature decrease minimum values.

LONG LIFE AND HIGH QUALITY

Our manufacturing can be made according to acceptable general standards. To be use A1 quality boiler metal sheet, consequently boiler lifetime so long. To be leave from producing every boiler, according to 3 bar operating pressure, to be test with 5 bar hydrostatic pressure. Through the using gasket covers, to furnish complete imperviousness.



- 1 Cleaning Cover
- 2 Fuel Feeding Cover
- 3 Ash Taking Cover
- 4 Digital Control Panel
- 5 Lifting Hook
- 6 Fume Pipes
- 7 Flame Breaking Slices
- 8 Chimney
- 9 Fume Chest
- 10 Fume Chest Cleaning Cover
- 11 Manuel Chimney Tab
- 12 Boiler Outlet
- 13 Boiler Return
- 14 Safety Outlet
- 15 Safety Return
- 16 Safety Ventil Inlet
- 17 Reducer
- 18 Fan
- 19 Spiral
- 20 Bunker
- 21 With Water Safety System
- 22 Gear Safety System
- 23 Automatic Ignition

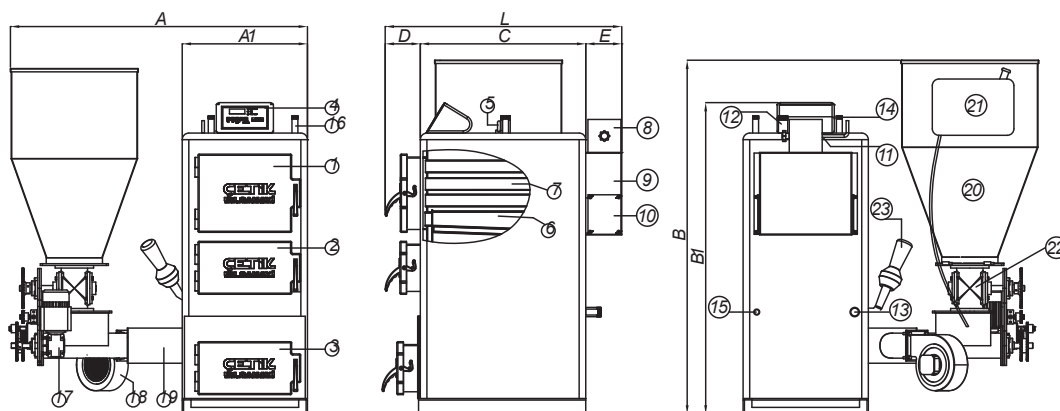

TECHNICAL SIZES

MODEL	A1 mm	A mm	D mm	C mm	E mm	L mm	B1 mm	B mm	BOILER		SAFETY		CHIMNEY DIAMETER mm
									OUTLET inch (")	RETURN inch (")	OUTLET inch (")	RETURN inch (")	
EKO BS- 20	520	1420	180	535	160	875	1235	1455	1	1	3/4	3/4	130
EKO BS- 30	575	1485	180	585	160	925	1395	1590	1 1/4	1 1/4	3/4	3/4	130
EKO BS- 40	575	1535	180	685	160	1025	1425	1625	1 1/4	1 1/4	3/4	3/4	150
EKO BS- 60	675	1665	180	835	190	1205	1490	1690	1 1/2	1 1/2	1	1	180
EKO BS- 80	735	1795	250	1120	340	1710	1820	2010	2	2	1	1	200
EKO BS- 100	850	2250	250	1220	340	1810	1960	2150	2	2	1	1	200
EKO BS- 125	900	2300	250	1320	390	1960	1850	2040	Ø65	Ø65	1 1/2	1 1/2	200

TECHNICAL FEATURES

		EKO BS-20	EKO BS-30	EKO BS-40	EKO BS-60	EKO BS-80	EKO BS-100	EKO BS-125
HEATING CAPACITY (Coal 7500 kcal/kg)	kW	23	34	46	69	93	116	145
	kcal/h	20,000	30,000	40,000	60,000	80,000	100,000	125,000
WATER CAPACITY	liter	60	85	120	195	255	295	325
WEIGHT	kg	330	400	450	555	775	885	1010
WORKING PRESSURE (max)	bar	3	3	3	3	3	3	3
TEST PRESSURE	bar	5	5	5	5	5	5	5
MAX. BOILER OUTLET WATER TEMPERATURE	°C	90	90	90	90	90	90	90
ASHTRAY CAPACITY	liter	10	13	15	21	28	35	44
NOMINAL VOLTAGE	V	220	220	220	220	220	220	220
WORKING FREQUENCY	Hz	50	50	50	50	50	50	50
REDUCER MOTOR POWER	W	250	250	250	250	250	1500	1500
FAN POWER	W	125	180	180	180	180	370	370

SOLID FUEL-AUTOMATIC FEEDING CENTRAL HEATING BOILER

EKO KBS SERIES

FUME TUBULAR, RADIATION STYLE



HIGH EFFICIENCY

EKO KBS series of solid fuel boilers ergonomic control panel, designed on the basis of the combustion pressure inside the structure, and lower than auto fuel-fed fire pot sliding system operates with high efficiency. Turbulators smoke pipe is placed on heat combustion caused by preventing the mast from the shaft to increase the efficiency of the boiler.

USING FACILITY

Cause of with large volumes of bunker, it storage so much fuel. User can easily and clearly see all adjustment details from LCD display on to the digital control panel. Boiler works high efficient and economically after setting adjustment by high sensitive digital control panel.

BURNING CONTROL SYSTEM

Boiler-circulation pump working temperature, fuel loading-delay time adjustment and fan speed control can easily adjust by digital control panel and after this air disperse in to the boiler homogeneous. Boiler reaches to regime in a shortly time. Fan and reducer switch off and boiler stay sleeping mode after entering the adjusted boiler temperature. Fuel loading and waiting (delay) time can easily adjust by user according to air conditions and building positions. Adjusting time's flow chart and working position can display on LCD screen. Fuel is loading by spiral in to the combustion chamber from below so that fire never burn out.

FUEL SPECIALITIES

EKO KBS series of solid-fuel boiler, nut coal, pellet, pomace, fruit pits, nut shells were burned in a high combustion efficiency and low flue gas emissions, is designed to provide. Boilers with cover and automatic loading system modification can be converted into liquid and gaseous fuels. In this way, conversion gain of approximately 50% increase in capacity allows.

HIGH SAFETY

Boiler water temperature can adjust on to the digital control panel. Limit thermostat shut down the reducer and fan when the boiler temperature exceeds the 90°C but circulation pump continues to work. Circulation pump working temperature can adjust between 10°C and 45°C. If water temperature fall down +4°C, circulation pump work automatically for blocking the freezing risk. No any firing from the combustion chamber to the bunker, thanks to gear protect system and with water grill system.

AESTHETIC DESIGN

Control panel is adaptation with boiler body completely thanks to panel's special design. Boiler body is isolated completely for heat losing and also water grill absorb the heat. Boiler outside view is painted with electrostatic paint and this gives the boiler aesthetic view.

ENVIRONMENT FRIEND

Due to special interior design and sensitive working digital control panel, benefit maximum from burning and after burning gases. Also harmful waste gases and chimney temperature decrease minimum values.

LONG LIFE AND HIGH QUALITY

Our manufacturing can be made according to acceptable general standards. To be use A1 quality boiler metal sheet, consequently boiler lifetime so long. To be leave from producing every boiler, according to 3 bar operating pressure, to be test with 5 bar hydrostatic pressure. Through the using gasket covers, to furnish complete imperviousness. To be used high isolation over the 1.000 centigrade degree, durable of the high temperature refractor concrete at the boiler covers.



- 1 Front Cover
- 2 Fuel Feeding Cover
- 3 Ash Taking Cover
- 4 Digital Control Panel
- 5 Boiler Outlet
- 6 Safety Outlet
- 7 Lifting Hook
- 8 Boiler Return
- 9 Safety Return
- 10 Fume Chest
- 11 Chimney
- 12 Manuel Chimney Tab
- 13 Balst Cover
- 14 Filling-Discharging
- 15 Bunker
- 16 Reducer
- 17 Spiral
- 18 Fan

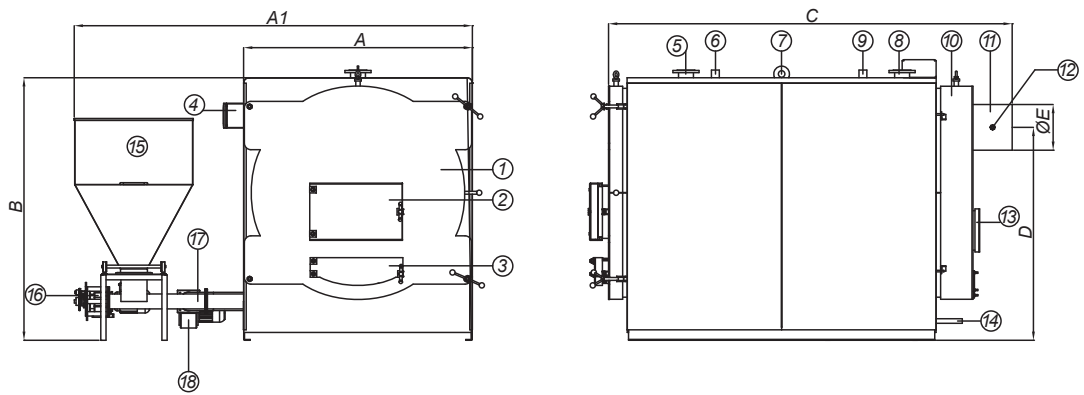

TECHNICAL SIZES

MODEL	CAPACITY		A	A1	B	C	D	E (Ø)	BOILER		SAFETY		BOILER FILLING DISCHARGE	WEIGHT	WATER CAPACITY
									OUTLET	RETURN	OUTLET	RETURN			
	kcal/h	kW	mm	mm	mm	mm	mm	mm	mm	mm	inch (")	mm	inch (")	kg	lt
EKO KBS-150	150,000	174	1180	2245	1390	2205	1090	250	65	65	1 1/4	1 1/4	3/4	1580	900
EKO KBS-175	175,000	203	1230	2295	1470	2325	1120	250	65	65	1 1/4	1 1/4	3/4	1800	1200
EKO KBS-200	200,000	233	1300	2365	1540	2365	1175	300	65	65	1 1/2	1 1/2	3/4	2070	1350
EKO KBS-250	250,000	291	1340	2405	1550	2605	1205	300	80	80	1 1/2	1 1/2	3/4	2280	1470
EKO KBS-300	300,000	349	1440	2505	1650	2845	1295	300	80	80	1 1/2	1 1/2	3/4	2870	2020
EKO KBS-350	350,000	407	1500	2565	1710	2875	1360	300	80	80	1 1/2	1 1/2	3/4	3370	2080
EKO KBS-400	400,000	465	1600	2900	1860	2935	1360	300	80	80	1 1/2	1 1/2	3/4	3610	2300
EKO KBS-450	450,000	523	1660	2960	1920	3050	1395	350	100	100	1 1/2	1 1/2	3/4	3890	2570
EKO KBS-500	500,000	581	1720	3020	1980	3050	1455	350	100	100	1 1/2	1 1/2	3/4	4010	2450
EKO KBS-600	600,000	698	1750	3050	2010	3090	1480	350	125	125	2	2	3/4	4580	2690
EKO KBS-700	700,000	814	1860	3160	2150	3140	1620	350	125	125	2	2	3/4	5160	3200
EKO KBS-800	800,000	930	1960	3260	2250	3275	1670	400	125	125	2 1/2	2 1/2	3/4	5650	3500

LIQUID GAS FUEL CENTRAL HEATING BOILER

EKO SG SERIES

4 PASSING WAYS, BLAZE CRACKING SLICES

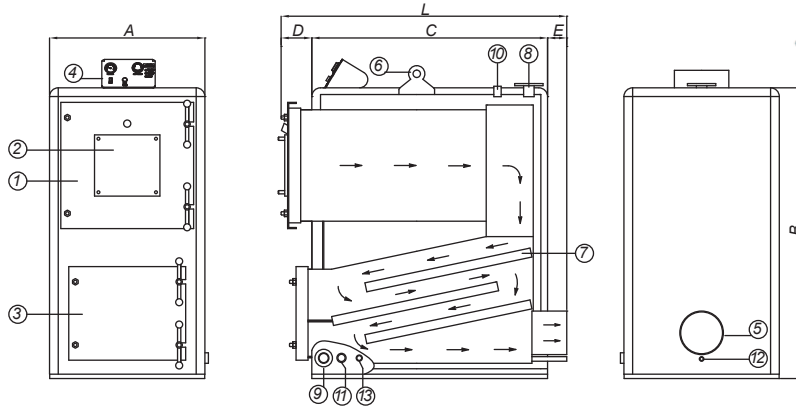

- | | |
|-------------------------|------------------------|
| 1 Front Cover | 8 Boiler Outlet |
| 2 Burner Flange | 9 Boiler Return |
| 3 Cleaning Cover | 10 Safety Outlet |
| 4 Control Panel | 11 Safety Return |
| 5 Chimney | 12 Condensing Outlet |
| 6 Lifting Hook | 13 Filling-Discharging |
| 7 Flame Breaking Slices | |

- ÇETİK ISI SANAYİ EKO SG series manufacturing between 75.000-800.000 kcal/h capacity and 13 models.
- EKO SG series through special interior design has got %92 efficiency.
- It is working as without problem, with natural gas, LPG, Fuel Oil and with diesel fuel.
- Interior design is come into being, steel body and 4 transition system. Through this system, heat transfer and efficiency is very high. Through from special interior design, burning and after burning out of gas, take as maximum degree, harmful effluent gas and chimney heating to be lowered minimum value. When the using acceptable burner, chimney output gas heating not exceeding 180 degree.
- Control panel usable is very easy.
- Through the with hang burner and cleaning cover, combustion chamber and slices can be clean as very easy.
- At the Boiler, use the refractor concrete and through heat losing.
- Boiler water heat can be control from on the control panel. Control panel has got necessary equipment, for the Boiler safety working.
- Perfect heat insulation for the Boiler, and external interview electrostatic paint, for this it has got very aesthetic.
- Our manufacturing is acceptable according to TSE and International Standards. Boiler steel is high quality and long life for that reason boiler life is longer than others.

TECHNICAL SIZES

MODEL	CAPACITY		A	B	C	D	E	L	BOILER		SAFETY		CHIMNEY DIAMETER	WEIGHT	WATER CAPACITY
	kcal/h	kW							OUTLET	RETURN	OUTLET	RETURN			
			mm	mm	mm	mm	mm	mm	mm	mm	inch (")	inch (")	mm	kg	lt
EKO SG-75	75,000	87	560	1100	800	100	100	1000	1 1/2"	1 1/2"	1 1/4	1 1/4	150	375	100
EKO SG-100	100,000	116	715	1230	965	100	100	1165	50	50	1 1/4	1 1/4	150	490	175
EKO SG-150	150,000	174	715	1390	1115	100	100	1315	65	65	1 1/4	1 1/4	200	655	290
EKO SG-200	200,000	232	815	1440	1315	100	100	1515	65	65	1 1/2	1 1/2	200	945	420
EKO SG-250	250,000	290	915	1500	1525	100	100	1725	80	80	1 1/2	1 1/2	250	1195	565
EKO SG-300	300,000	348	1015	1545	1545	170	100	1815	80	80	2	2	200x250	1515	680
EKO SG-350	350,000	406	1080	1590	1590	170	100	1860	100	100	2	2	200x250	1820	775
EKO SG-400	400,000	465	1135	1620	1620	170	100	1890	100	100	2	2	250x350	1970	845
EKO SG-450	450,000	523	1190	1650	1650	170	100	1920	100	100	2	2	250x350	2425	905
EKO SG-500	500,000	581	1250	1675	1675	170	100	1945	100	100	2	2	250x400	2570	970
EKO SG-600	600,000	697	1355	1710	1710	170	100	1980	100	100	2 1/2	2 1/2	250x400	3250	1100
EKO SG-700	700,000	813	1480	1800	1800	170	100	2070	125	125	2 1/2	2 1/2	300x400	3960	1245
EKO SG-800	800,000	930	1600	1875	1875	170	100	2145	125	125	2 1/2	2 1/2	300x400	4655	1375



LIQUID GAS FUEL CENTRAL HEATING BOILER

EKO KBSG SERIES

FUME TUBULAR, OPPOSITE PRESSURE

- | | |
|-----------------|------------------------|
| 1 Front Cover | 7 Boiler Return |
| 2 Burner Flange | 8 Safety Return |
| 3 Control Panel | 9 Fume Chest |
| 4 Boiler Outlet | 10 Chimney |
| 5 Safety Outlet | 11 Balst Cover |
| 6 Lifting Hook | 12 Filling-Discharging |

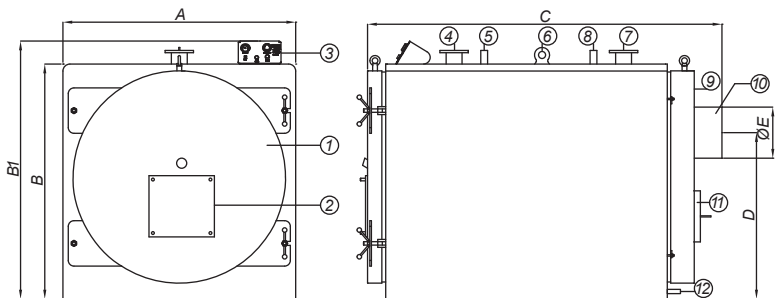

- EKO KBSG series through special interior design has got %92 efficiency.
- It is working as without problem, with natural gas, LPG, Fuel Oil and with diesel fuel.
- The principle of working with our boiler, win against the pressure, by turning back half of flames burned in the same cell of the incomplete combustion of fuel particles are provided.
- Turbulators smoke pipe is placed in the heat of combustion resulting directly from the shaft increases the efficiency of the boiler to prevent
- Control panel usable is very easy.
- Thanks to with hinged front cover , you can easily arrive to fireplace area.
- At the Boiler, use over the 1.000 centigrade degree, durable of the high temperature refractor concrete is using and through heat losing.
- Boiler water heat can be control from on the control panel. Control panel has got necessary equipment, for the Boiler safety working.
- Perfect heat insulation for the Boiler, and external interview electrostatic paint, for this it has got very aesthetic.
- Our manufacturing is acceptable according to standards. Boiler steel is high quality and long life, for that reason boiler life is longer than others.

TECHNICAL SIZES

MODEL	CAPACITY		A	B	B1	C	D	E (ø)	BOILER		SAFETY		BOILER FILLING DISCHARGE	WEIGHT	WATER CAPACITY
	kcal/h	kW							OUTLET	RETURN	OUTLET	RETURN			
			mm	mm	mm	mm	mm	mm	mm	mm	inch (")	inch (")	inch (")	kg	lt
EKO KBSG-100	100,000	116	815	860	960	1450	630	200	50	50	1 1/4	1 1/4	3/4	630	140
EKO KBSG-125	125,000	145	815	860	960	1550	650	200	65	65	1 1/4	1 1/4	3/4	735	290
EKO KBSG-150	150,000	174	885	940	1040	1550	700	200	65	65	1 1/4	1 1/4	3/4	770	300
EKO KBSG-175	175,000	203	885	940	1040	1650	750	200	65	65	1 1/4	1 1/4	3/4	820	350
EKO KBSG-200	200,000	233	935	1000	1100	1680	750	250	65	65	1 1/2	1 1/2	3/4	930	410
EKO KBSG-250	250,000	291	1020	1070	1170	2050	785	250	80	80	1 1/2	1 1/2	3/4	1165	500
EKO KBSG-300	300,000	349	1120	1170	1270	2080	860	300	80	80	1 1/2	1 1/2	3/4	1250	600
EKO KBSG-350	350,000	407	1120	1170	1270	2180	860	300	80	80	1 1/2	1 1/2	3/4	1380	660
EKO KBSG-400	400,000	465	1220	1270	1370	2280	900	300	80	80	1 1/2	1 1/2	3/4	1540	780
EKO KBSG-450	450,000	523	1320	1370	1470	2380	950	350	100	100	1 1/2	1 1/2	3/4	1610	960
EKO KBSG-500	500,000	581	1320	1370	1470	2450	1020	350	100	100	1 1/2	1 1/2	3/4	1700	1200
EKO KBSG-600	600,000	698	1400	1450	1550	2600	1020	350	125	125	2	2	3/4	2230	1350
EKO KBSG-700	700,000	814	1450	1450	1550	2750	1100	400	125	125	2	2	3/4	2425	1600
EKO KBSG-800	800,000	930	1500	1500	1600	2900	1150	400	125	125	2 1/2	2 1/2	3/4	2590	1840

FULL MODULATION WOOD PELLETS BOILER

EKO P SERIES



WHY PELLETT ?

When the trees are growing up, it takes CO₂ from air. When the ignite of the woods, that give out to environment again, necessary level of CO₂. Therefore, with Pellet Heating mean is, natural transform. Wood Pellet made from sawdust, to crop of the timber and 100% natural wood. This material is tightening under the very high pressure and it doesn't include any chemical or synthetic. Wood Pellet protect the environment Renewable and clean energy source. To standardize of with DIN 51371 or OENORM M7135.

1 kg wood Pellet = 4,9 kw 1m³ wood Pellet = 650 kg

CONFIDENTIAL, ECONOMIC AND MODERN SOLUTION

Thanks to EKO P series, you can get possession your all wishes comfort and Heating. This product has got, with elegant line, absolute disagn and perfect workmanship. Compact disagn for easy montage. You put your wishes Pellet, to Pellet depot. You make your all settings from large graphic screen and two button discs, it start and then you forgot to near the coming again.

HIGH EFFICIENCY, LOW POWER MANAGEMENT, MAXIMUM DURABILITY AND MINIMUM MAINTENANCE...

WITH INNOVATIVE TECHNOLOGY AS 93% HIGH EFFICIENCY...

According to burning adjustment first and second air system, manufacturing from stainless steel and thanks to special disagn burning potash and burning circle, that burning room temperature increase till 1000 centigrade degree and it provides all gases burning. This boiler works with 3 passing ways boiler disagn and high efficiency.

CONTROL OF THE LAMBDA SENSOR...

With this system, measure necessary oxygen amount and all parameters give to the control panel. This control panel, to take into consideration of the necessary air amount and it adjust first air, second air and chimney fan working break. Cause of this, you can get low emission and clean burning.

AUTOMATIC BOILER CLEANING...

All ash collect on the heat converters and it lower Heating transfer and chimney Heating increase. We putted turbulator, between heat converters and this made from stainless steel. You will adjust all settings and all period breaks from control panel, it will move down-up and it cleans all ashes. Then, to let down all ashes to ash-store.

AUTOMATIC IGNITION...

On the burning potash fuel, it ignite with hot air and necessary burning is start. You can burn control with chimney sensor and you can see all informations from control panel.

AUTOMATIC ASH DISCHARGE...

When you adjust all settings and period breaks from control panel, all ashes to put out the ash-store. Thanks to the montage and easily of the carrying, ask bucket is put off from its place and it clean the out of the boiler room.

SECURE AND COMFORT HEATING...

On the loading spiral, it has got sensors. This sensors control Heating and fuel amount. Separately, it like it bridge, between stoker spiral and fuel moving spiral, again between of the flexible plastic hose and boiler. In this context, it provide extra security.

EASY CONTROL...

- Large screen, comprehensible menu and useful keys...
- Compatible software for the lambda sensor
- The modulation break , between all burden and partial burden ...
- Control of the Heating system...
- Control of the chimney heating...
- Control of the fuel amount...
- Control of the back-burn , with sensors...

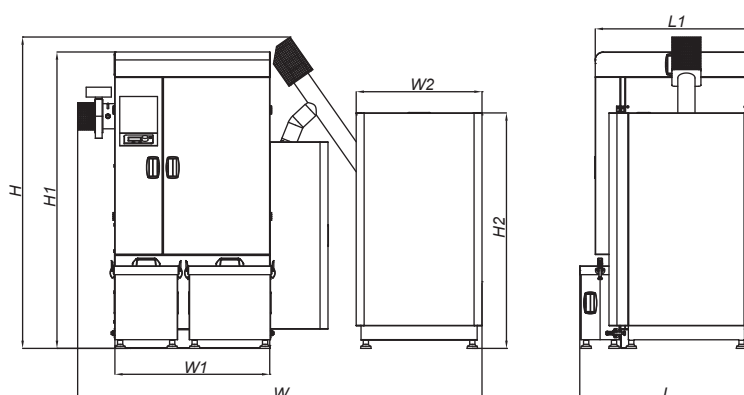

TECHNICAL FEATURES

		EKO PM-20	EKO PM-32
NOMINAL LOAD POWER	kW	20	32
PARTIAL LOAD POWER	kW	12.0	19.2
WATER CAPACITY	liter	42	56
BOILER WEIGHT	kg	490	560
MOBILE TANK WEIGHT	kg	70	70
WORKING PRESSURE (max)	bar	3	3
MAXIMUM BOILER WORKING TEMPERATURE	°C	90	90
MINIMUM BOILER RETURN WATER TEMPERATURE	°C	55	55
MOBILE TANK FUEL CAPACITY	liter	300	300
ELECTRICAL SYSTEM CONNECTION	V AC / Hz	230 / 50	230 / 50
FLUE GAS TEMPERATURE NOMINAL / PARTIAL LOAD	°C	120 / 85	140 / 95
FLUE PIPE DIAMETER	mm	130	130
BOILER OUTLET CONNECTION	inches	1"	1 1/4"
BOILER RETURN CONNECTION	inches	1"	1 1/4"
SAFETY CONNECTION	inches	3/4"	3/4"
FILL AND DRAIN CONNECTION	inches	1/2"	1/2"
BOILER DIMENSIONS			
W	mm	2180	2280
W1	mm	705	805
W2	mm	650	650
L	mm	890	890
L1	mm	812	812
H	mm	1745	1845
H1	mm	1432	1532
H2	mm	1217	1217

FULL MODULATION WOOD PELLETS BOILER

EKO P SERIES

- | | |
|------------------------|-----------------------|
| 1 Burner plate | 11 Secondary air fan |
| 2 Combustion ring | 12 Automatic ignition |
| 3 Heat exchanger | 13 Stoker spiral |
| 4 Turbulator | 14 Loading engine |
| 5 Chimney | 15 Fuel moving engine |
| 6 Lambda sensor | 16 Fuel moving spiral |
| 7 Draught fan | 17 Mobile tank |
| 8 Ash discharge system | 18 Clening Cover |
| 9 Cleaning engine | 19 Control Panel |
| 10 Primary air fan | |

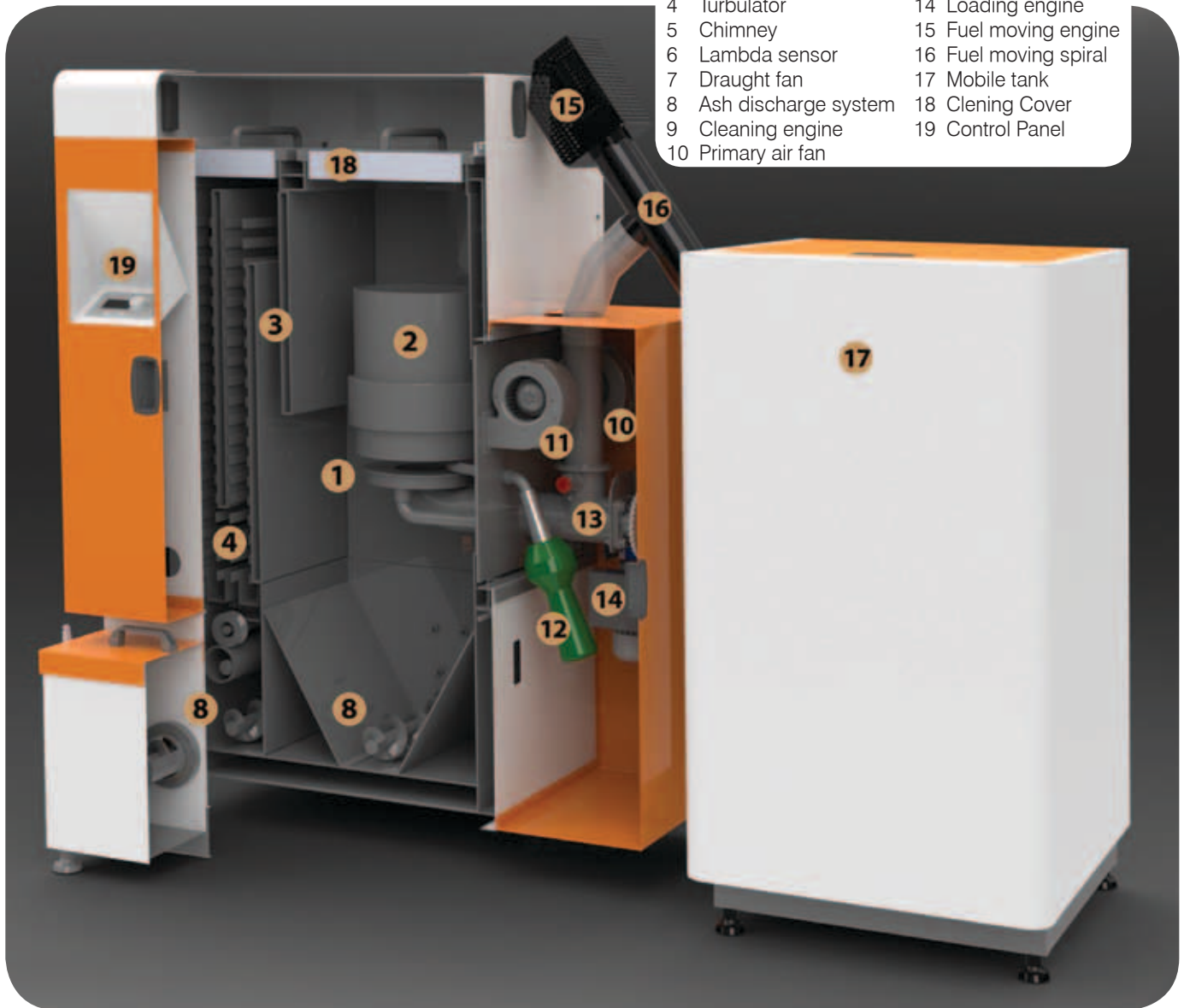

SOLID FUEL-AUTOMATIC FEEDING HOT AIR GENERATOR

EKO T SERIES

4 PASSING WAYS, BLAZE CRACKING SLICES



- 1 Fuel Feeding Cover
- 2 Ash Taking Cover
- 3 Control Panel
- 4 Chimney
- 5 Lifting Hook
- 6 Flame Breaking Slices
- 7 Air Entry
- 8 Air Outlet
- 9 Cleaning Cover
- 10 Bunker
- 11 Fan
- 12 Spiral
- 13 Reducer

- Boiler is working as full automatic.
- Montage is acceptable to air passages. Fuel loading and burning process eventuate as full automatic.
- Through special interior design, efficiency is high and energy cost very low than LPG and diesel fuel.
- When the after working, come into regime and arrived to desired heating.
- Fuel feeding is from bottom and continual, for this blaze don't deflate.
- Perfect heat insulation for the Boiler, and external interview electrostatic paint, for this it has got very aesthetic.
- Through from special interior design, burning and after burning out of gas, take as maximum degree, harmful effluent gas and chimney heating to be lowered minimum value.
- Our manufacturing is acceptable according to TSE and International Standards. Boiler steel is high quality. And increase of the metal – sheet thickness, According to desired outlet temperature and long life for that reason boiler life is longer than others.

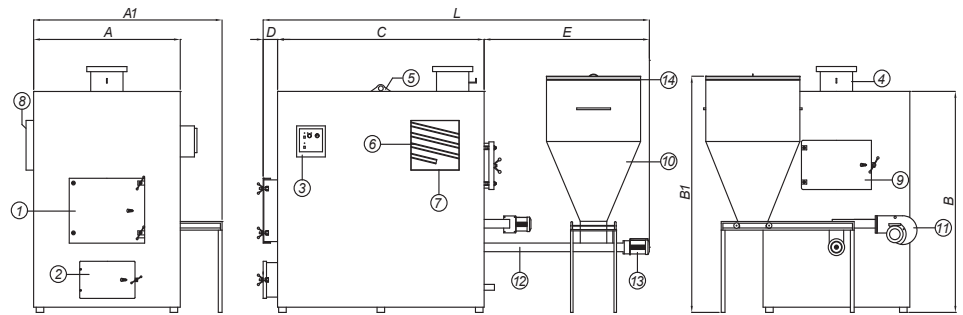

TECHNICAL SIZES

MODEL	A	A1	B	B1	C	D	E	L	CHIMNEY DIAMETER
	mm	mm	mm	mm	mm	mm	mm	mm	mm
EKO T-60	560	1310	1500	1650	1360	200	800	2360	150
EKO T-100	640	1390	1600	1850	1400	200	1000	2600	200
EKO T-150	740	1490	1650	1900	1560	200	1000	2760	250
EKO T-250	900	1650	1760	2010	1650	200	1000	2850	270
EKO T-350	1100	1850	1900	2200	1750	200	1000	2950	350

TECHNICAL FEATURES

		EKO T-60	EKO T-100	EKO T-150	EKO T-250	EKO T-350
HEATING CAPACITY (Coal 7500 kcal/kg)	kW	69	116	174	290	406
	kcal/h	60,000	100,000	150,000	250,000	350,000
AIR CAPACITY	m³/h	6,000	10,000	15,000	25,000	35,000
WEIGHT	kg	900	1200	1650	1800	1900
MAXIMUM BLOWING TEMPERATURE	°C	100	150	150	150	150
BUNKER FUEL CAPACITY	kg	225	300	300	500	500
ASHTRAY CAPACITY	liter	70	100	100	115	115
CONSUMPTION WORKING	W	2050	2050	2250	2250	2250
NOMINAL VOLTAGE	V	220	220	220	220	220
WORKING FREQUENCY	Hz	50	50	50	50	50
REDUCER MOTOR POWER	W	1500	1500	1500	1500	1500
FAN FLOW	m³/h	1900	1900	2400	2400	2400
FAN POWER	W	550	550	750	750	750
FAN SPEED	min ⁻¹	2900	2900	2900	2900	2900
FUEL TYPE	Hazelnut Coal, Pellet, Prina, Fruit Stones					



2. Organize Sanayi Bölgesi Büyük Kayacık Mahallesi
Reisköy Caddesi No:7 Konya/TÜRKİYE

T: +90 332 239 21 57 (pbx) • **F:** +90 332 239 21 58

www.cetikisisan.com.tr • bilgi@ cetikisisan.com.tr

IDM DINAMIC SRL BUZAU : 0238 711 042 / 0752 072 600

REPREZENTANTA IN ROMANIA

VANZARE & SERVICE LA NIVEL NATIONAL

POST: +90 332 239 21 58 (pbx)



www.kosgeb.gov.tr
Post Ajans A.Ş.

Basım Tarihi: 30/03/2012